

Jack David Feather

Architecture portfolio

UCAS ID 12663 80909

University of Nottingham

6/Dec/2016

3D Product & Photography

CounterpArt™ Reach™ Coffee capsule dispenser

AS-level Design & Technology: Product Design grade-A—Final product

American walnut, pine, maple ply, acrylic, copper

H 91cm x D 20cm

Canon EOS 7D Mk II: 1/8000 sec, f/2.8, ISO 100, 70mm



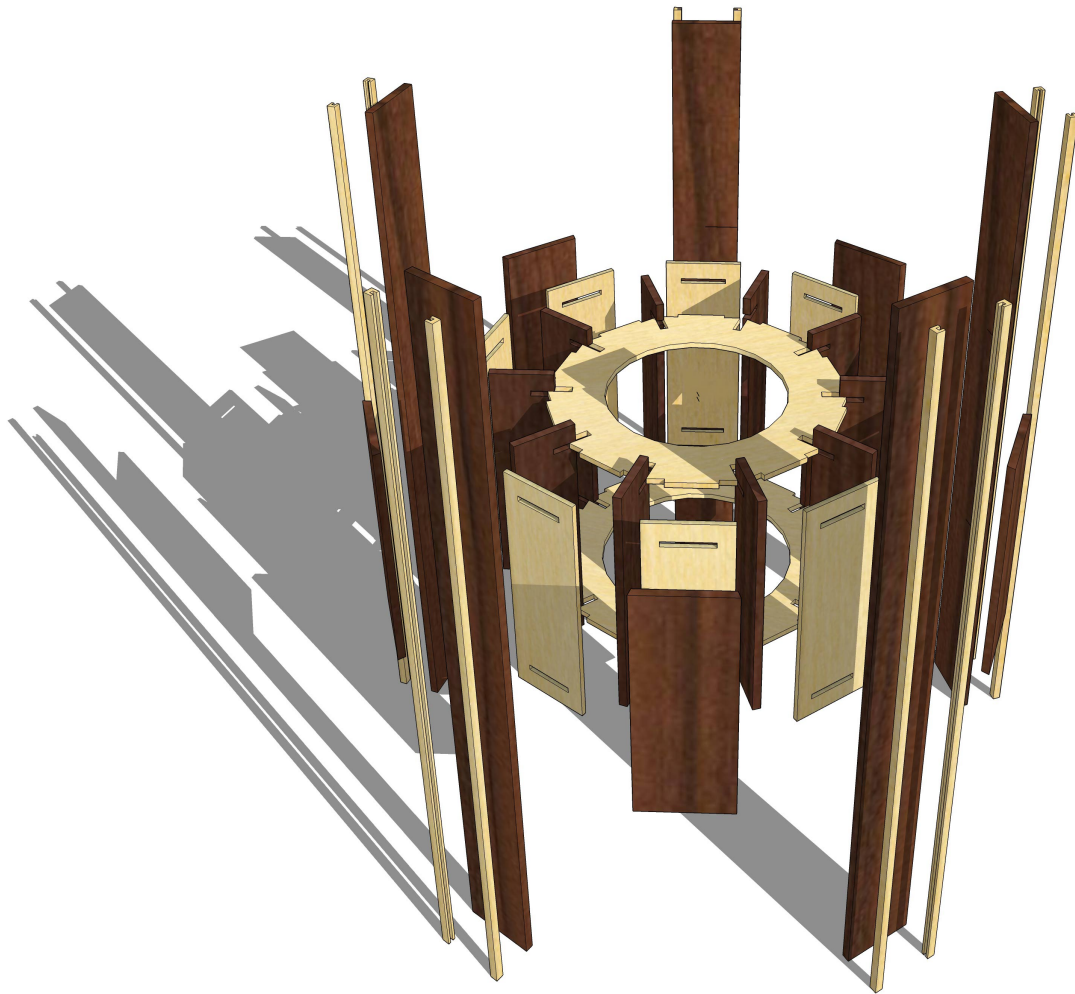

Development work & 3D Product

CounterArt™ Reach™ Coffee capsule dispenser

AS-level Design & Technology: Product Design grade-A—Final product

CAD exploded view & Close-up detail

The main structure of my frame is held together by 10 struts. The material I will use for the struts is walnut. The struts will be laser cut.

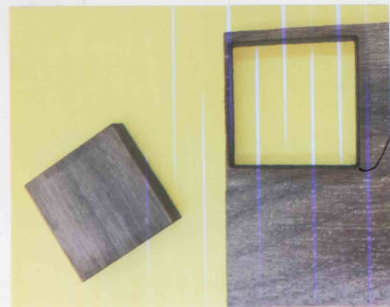
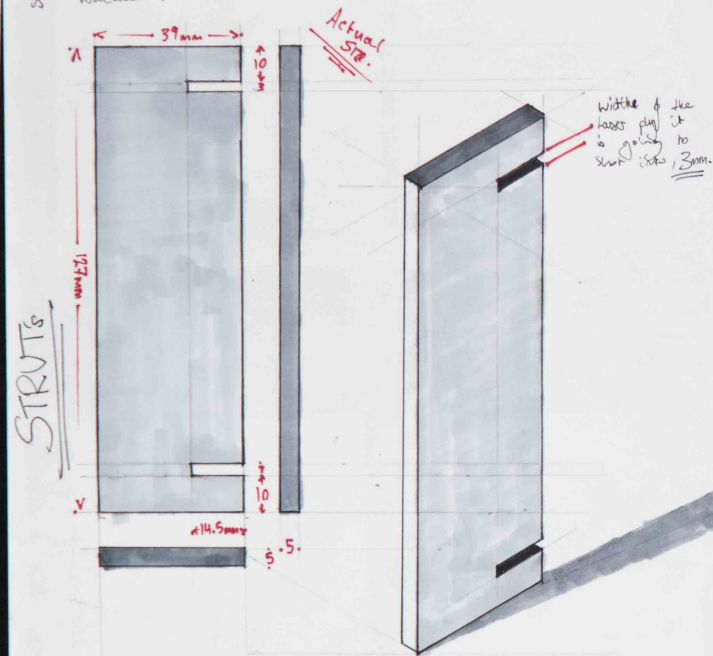

Here I tested laser cut settings for walnut and tested the aesthetics of cutting walnut pre-vented, turned out well. Spec pink! Slight border of melted wax, looks good to me.

Settings used -
POWER: 88
SPEED: 1.8
REPEATS: 2

Once I had tested laser cut settings I prepped the Walnut and started cutting.

RESULT



I then tested the cut walnut on the plywood CHH

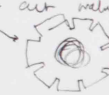

Walnut piece.

I found that leaving 3mm for the half housing was too high and caused the walnut to split along its grain. To solve this problem I made the gap 3.2 mm to allow the little wood some space. **DEVELOPMENT**

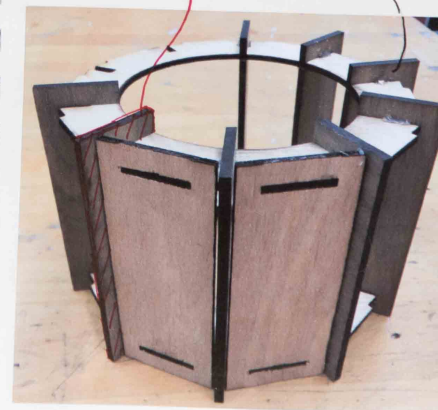

Development work & Modeling

CounterArt™ Reach™ Coffee capsule dispenser

AS-level Design & Technology: Product Design grade-A

Extract from sketchbook

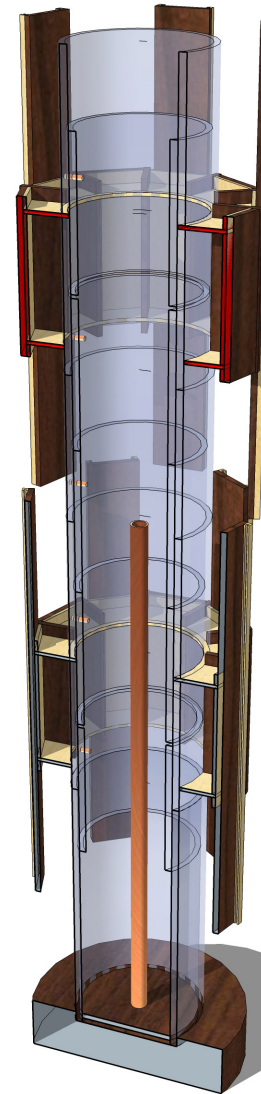
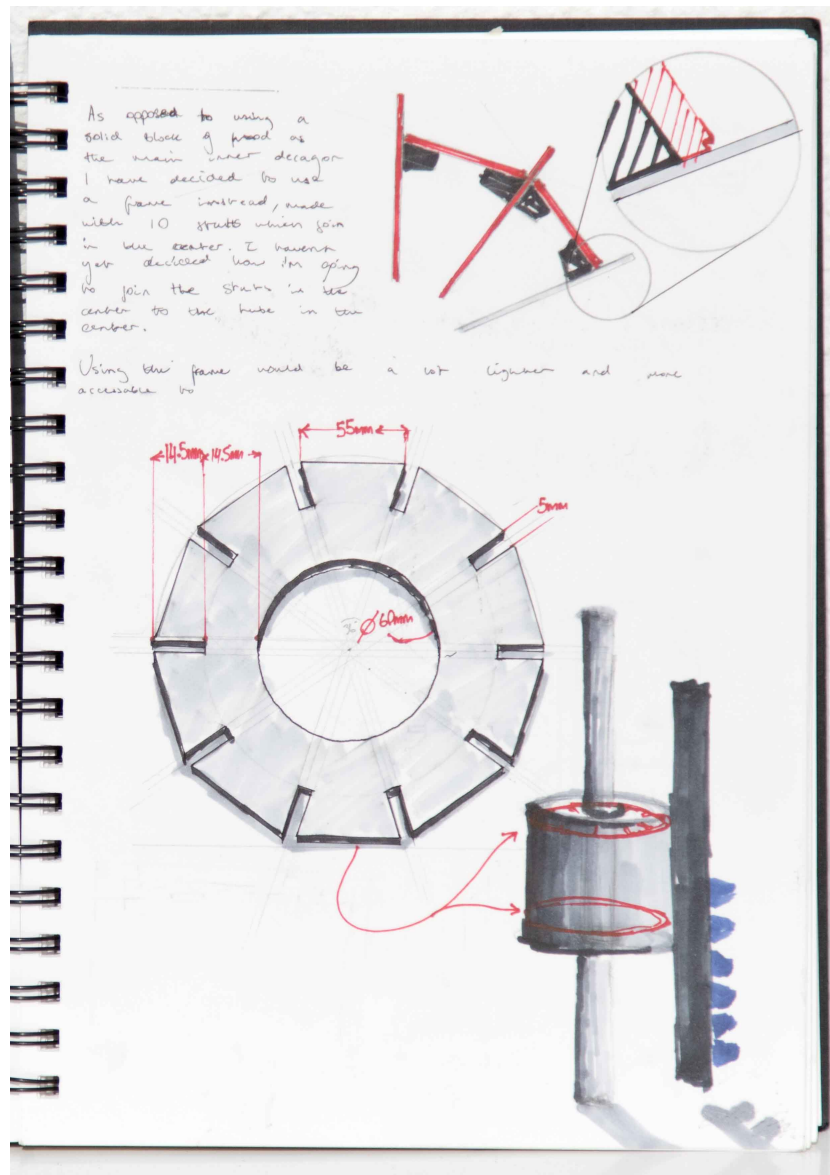

Development work

CounterArt™ Reach™ Coffee Capsule Dispenser

AS-level Design & Technology: Product Design grade-A
Extract from sketchbook & CAD section



Development work & 3D Modeling [6 of 32 models]

CounterArt™ Edo™ Coffee table

Design & Technology: Product Design

Pine doweling, MDF, beech, foam board

L 20cm x W 10cm x H 5cm

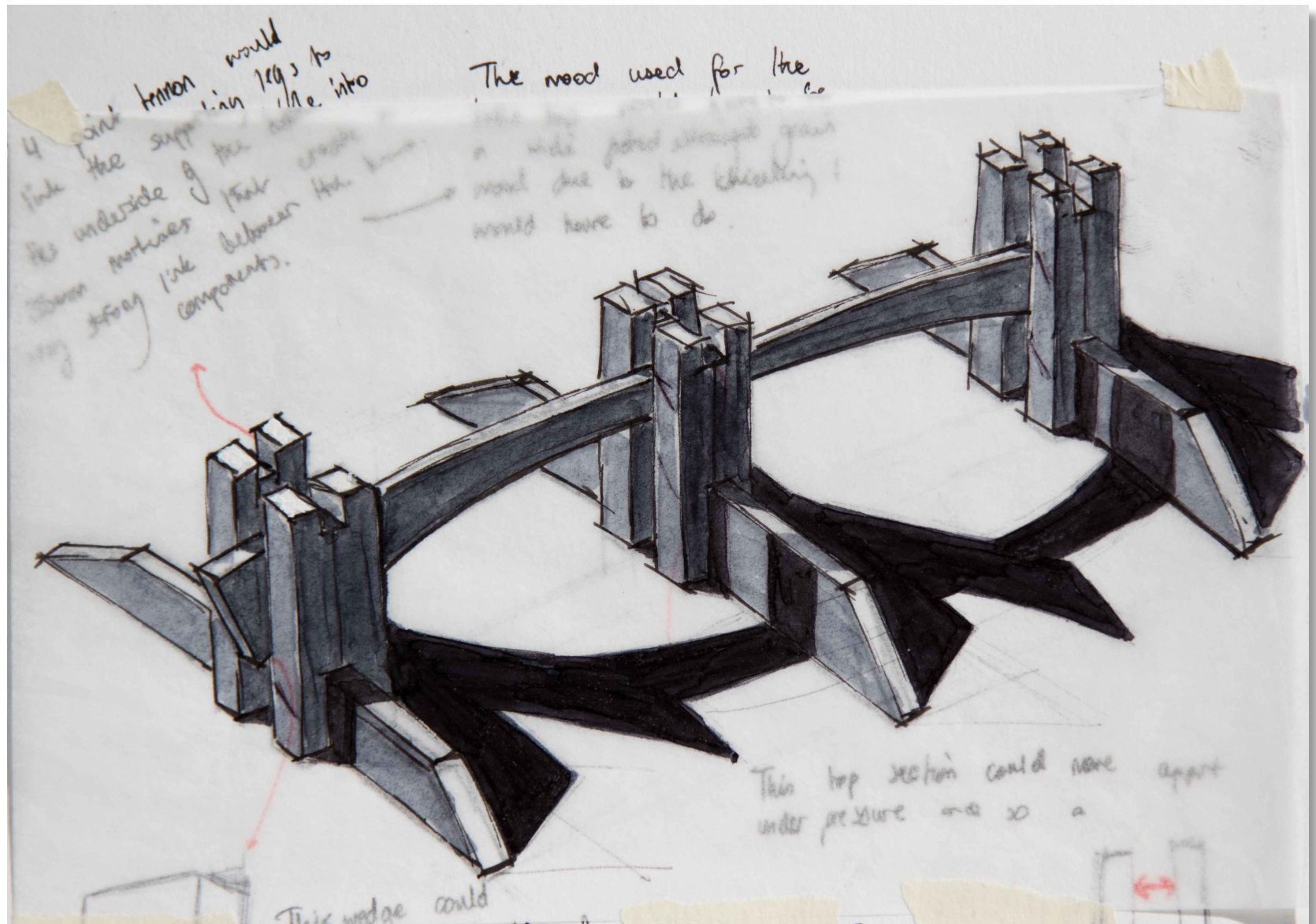

Development work & Hand-drawing
CounterArt™ Edo™ Coffee table
 Design & Technology: Product Design
 Copic markers & Fine Line pigment ink
 H 15cm x W 21cm



3D Product

CounterpArt™ Edo™ Coffee table

Design & Technology: Product Design—Pre-final piece

American walnut, Hard white maple

H 40cm x W 70cm x L 120cm

One of the CounterpArt™ range of bespoke living-art products, the design of this walnut and maple coffee table is inspired by Japanese architecture of the Edo period and built using techniques perfected by Sashimono carpenters. The table top is not yet complete.

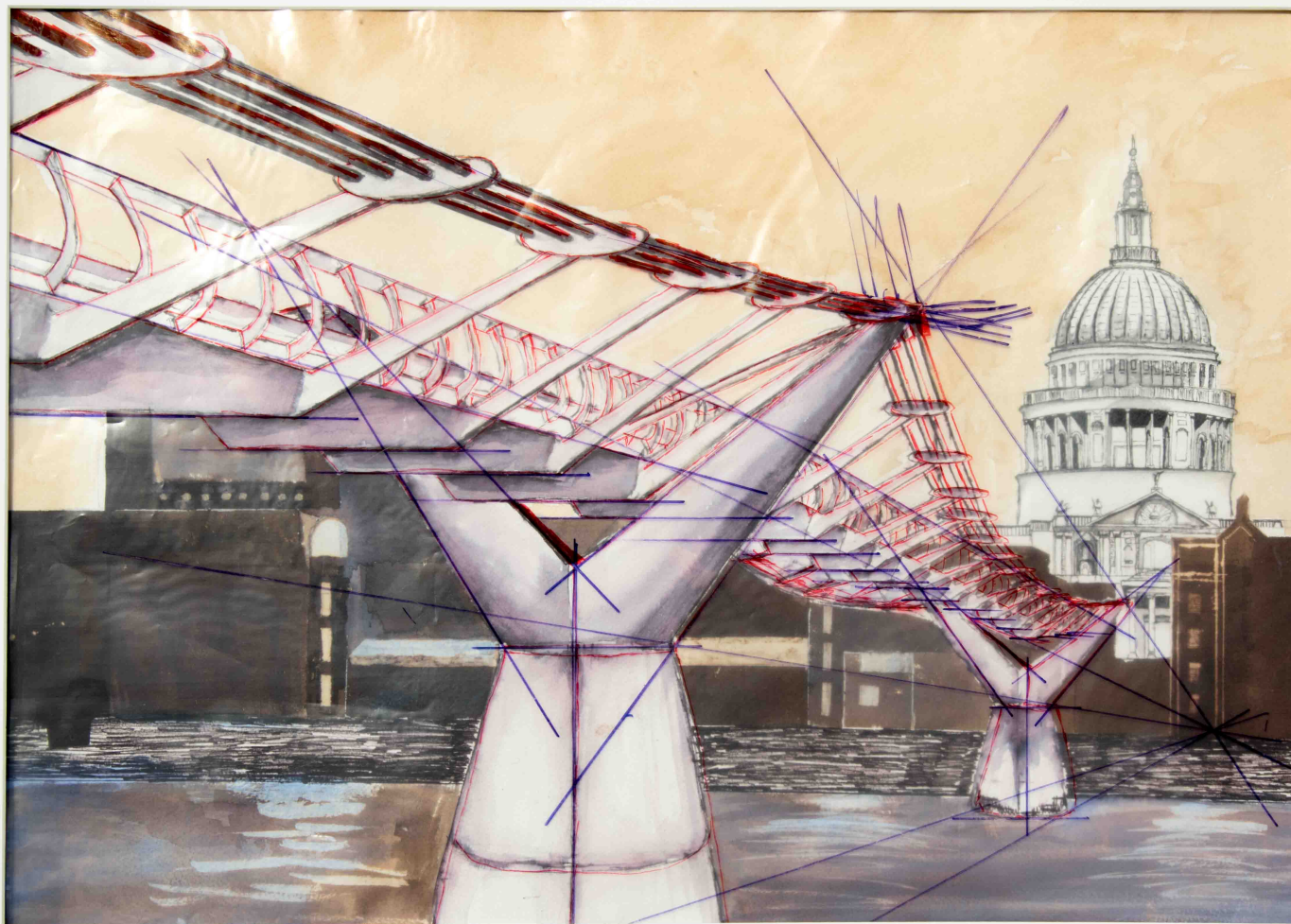

Art & Hand-drawing

Mark-making project—Millennium bridge and St Pauls

GCSE Art grade-A—Exam piece

Pen & water, ink, bleach, coffee, permanent markers, overlay on acetate

H 50cm x W 75cm

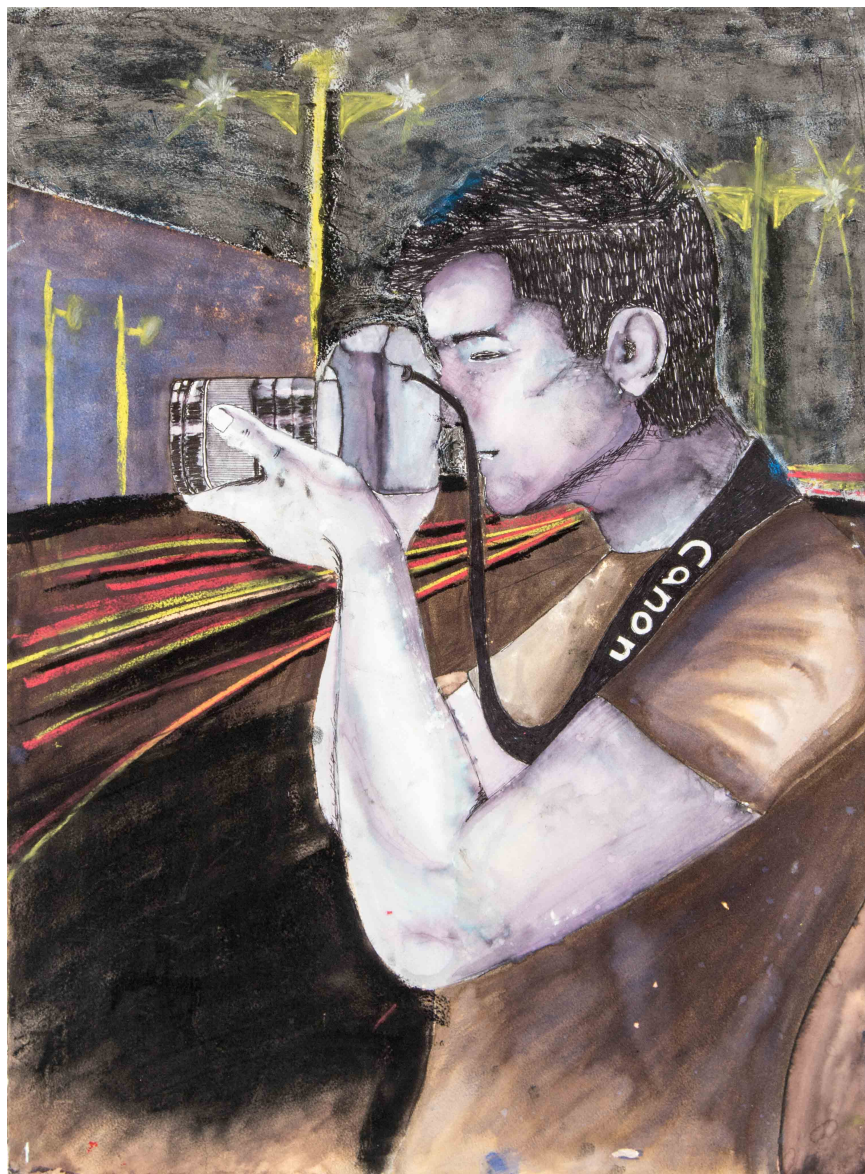

Art & Hand-drawing
'Through the lens' self-portrait
GCSE Art grade-A—Exam piece
Pen & water, ink, bleach, pastel
H 75cm x W 55cm

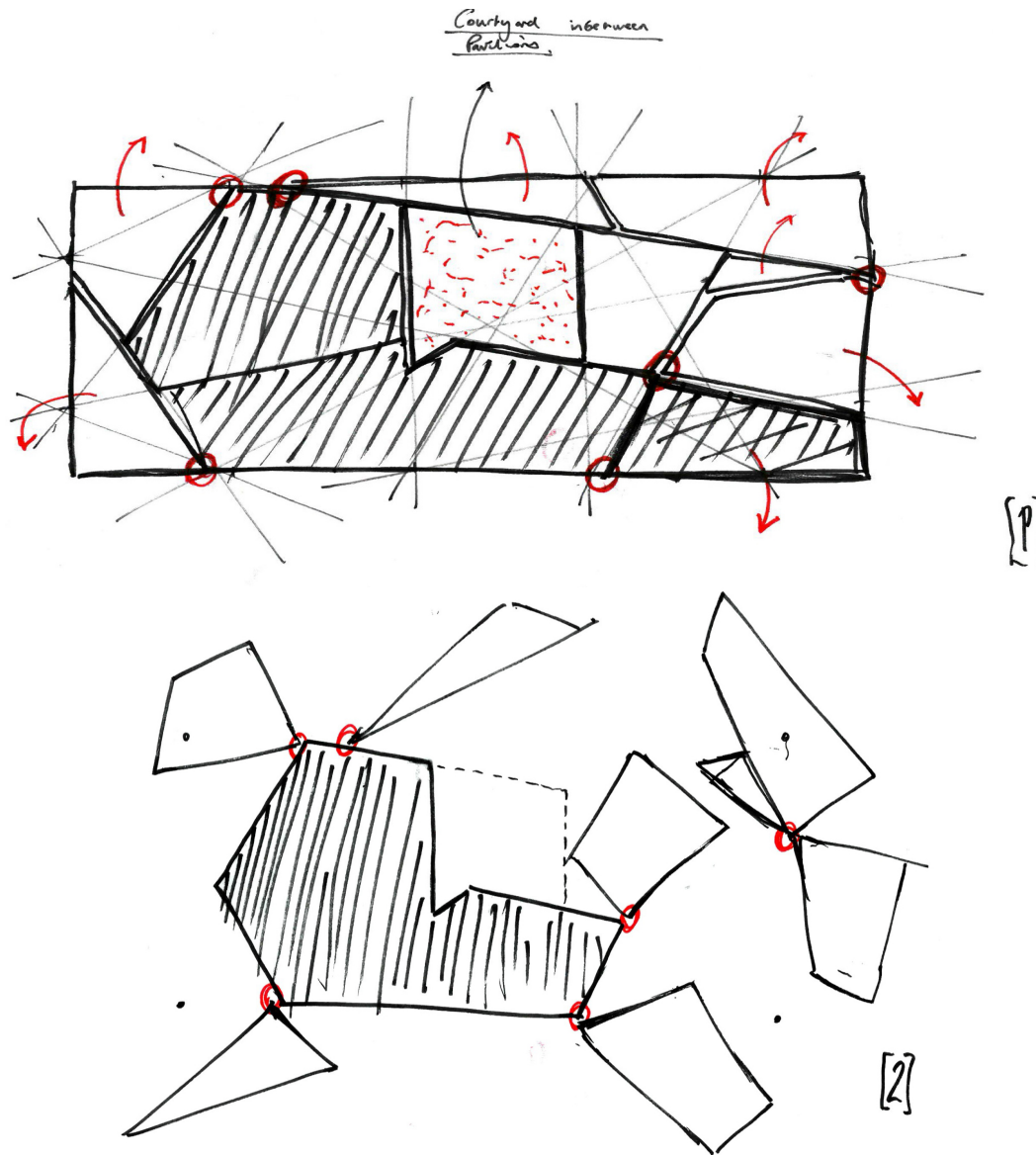

Development work [2 of 20+ sketches]

'All Hallows' Café Pavilion—Plan sketches

TP Bennett mini-internship—Architectural development

Felt pen

H 40cm x W 20cm

Project to design new community café in an urban park adjoining All Hallows church

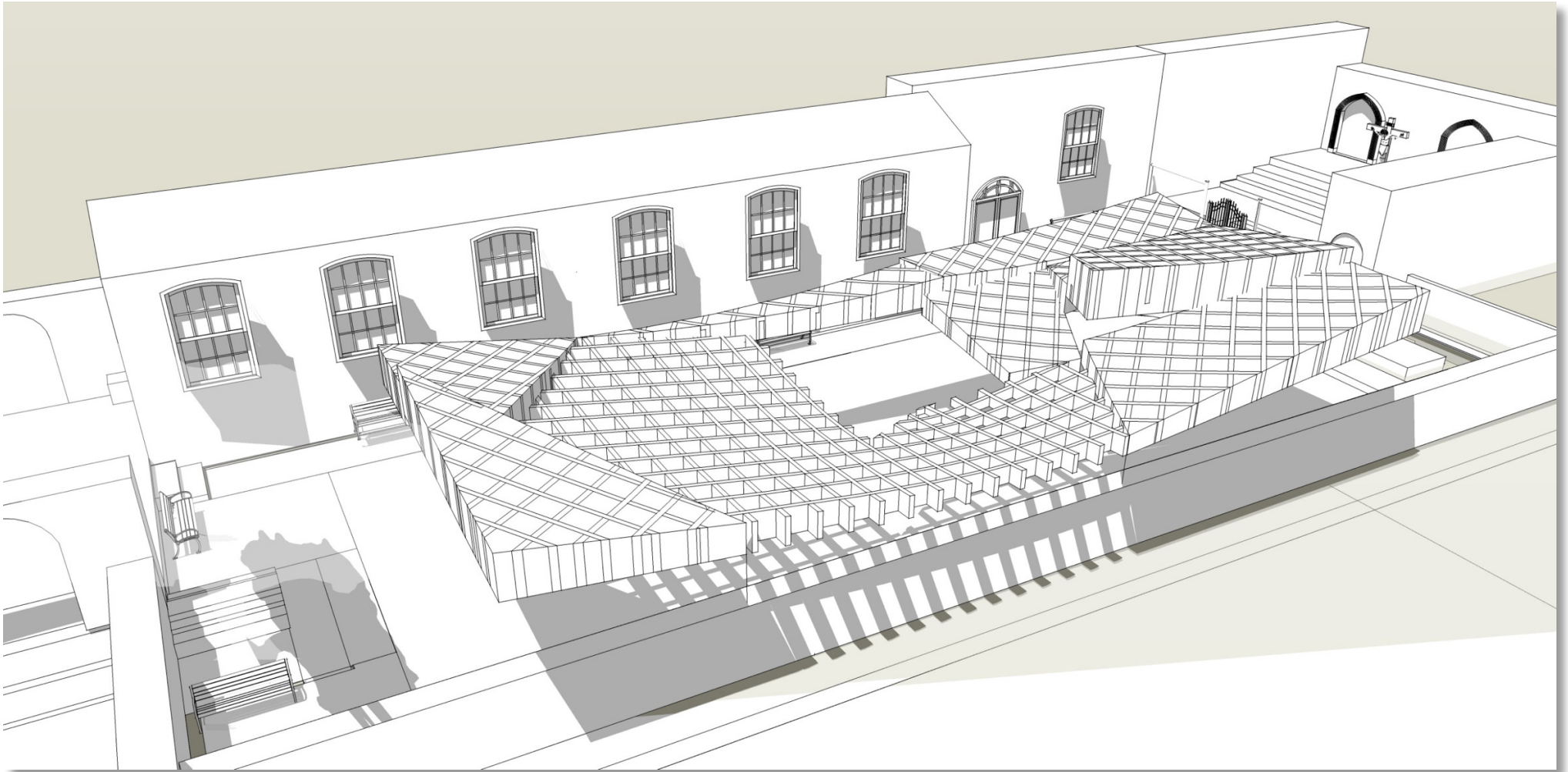

Architectural design solution

'All Hallows' Café Pavilion—CAD Rendering—Roof closed

TP Bennett mini-internship—Architectural development

H 3m x W 20m x L 30m

Pivoting Pavilion roofs. Making the most of good weather and position of sunlight creates an all-year-round courtyard space for the local community. Extensive project workflow with comprehensive deliverables, report and presentation to project team completed in only 4-days.

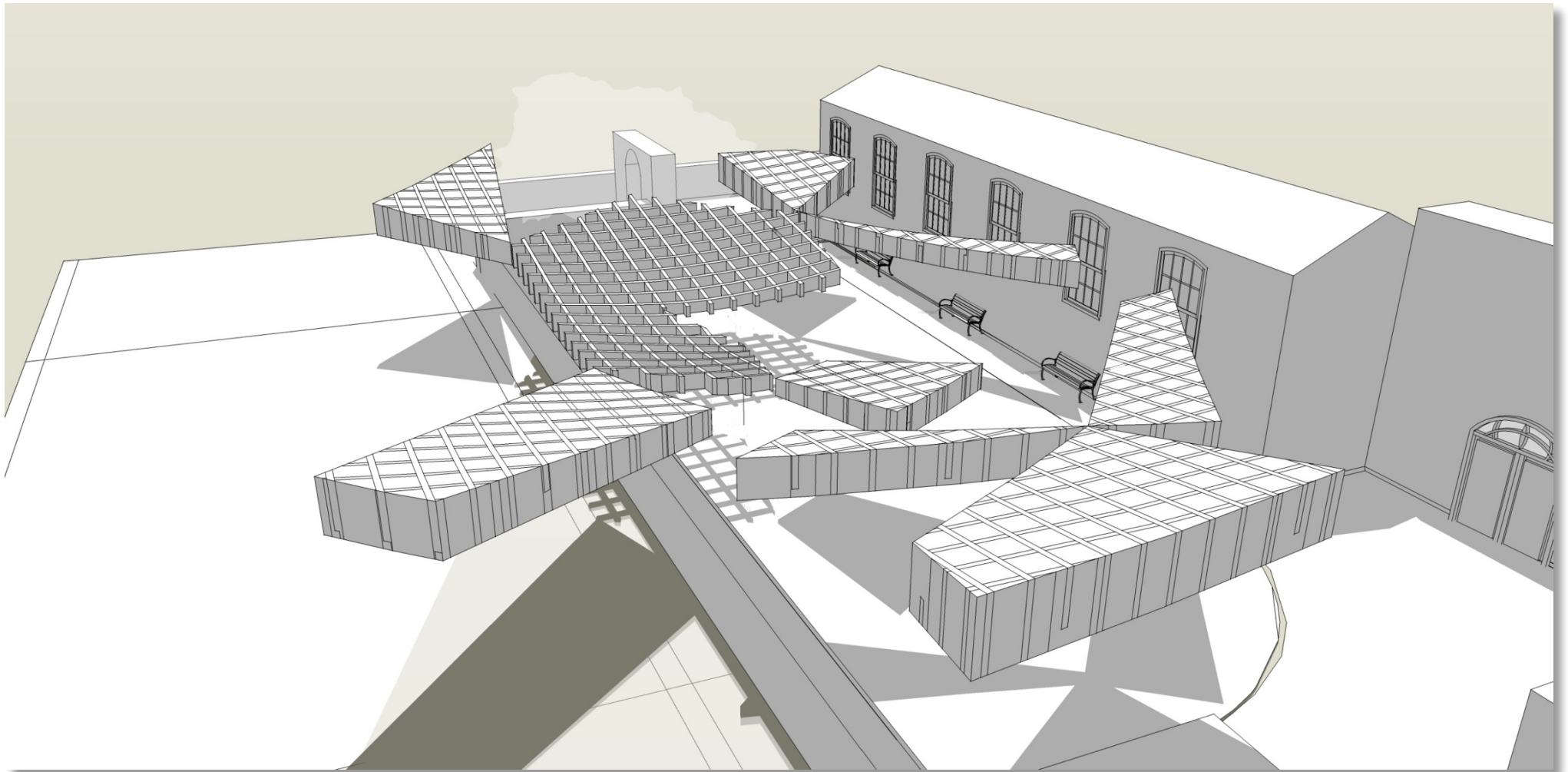

Architectural design solution
'All Hallows' Café Pavilion—CAD Rendering—Roof open
TP Bennett mini-internship—Architectural development
H 3m x W 20m x L 30m

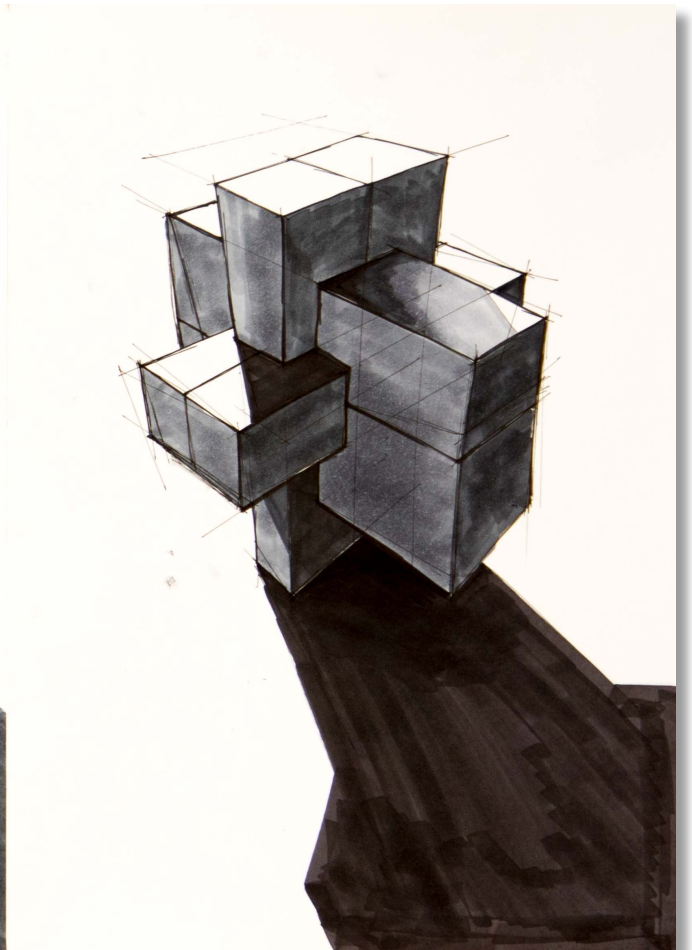
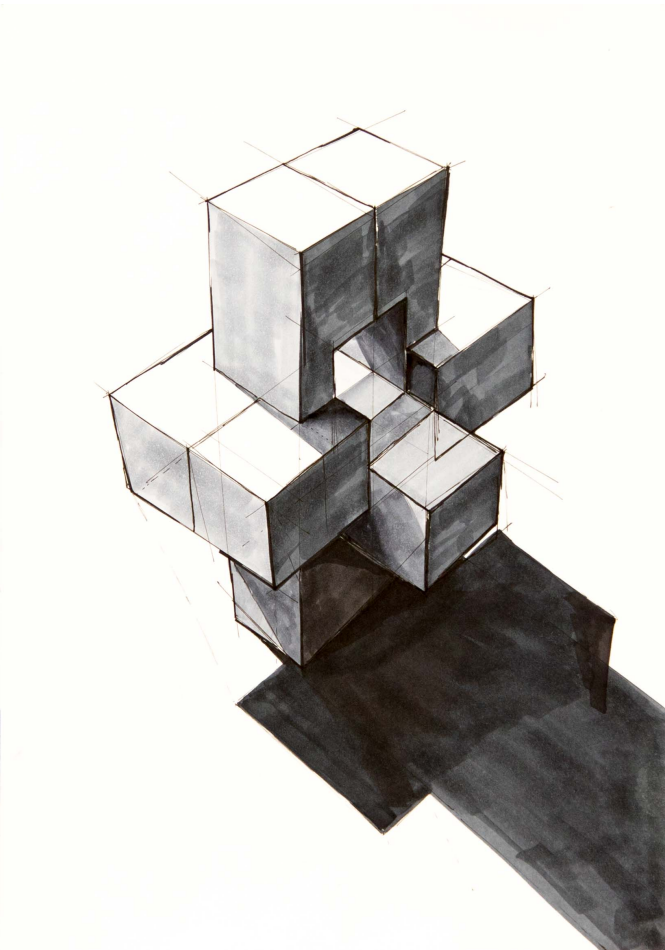
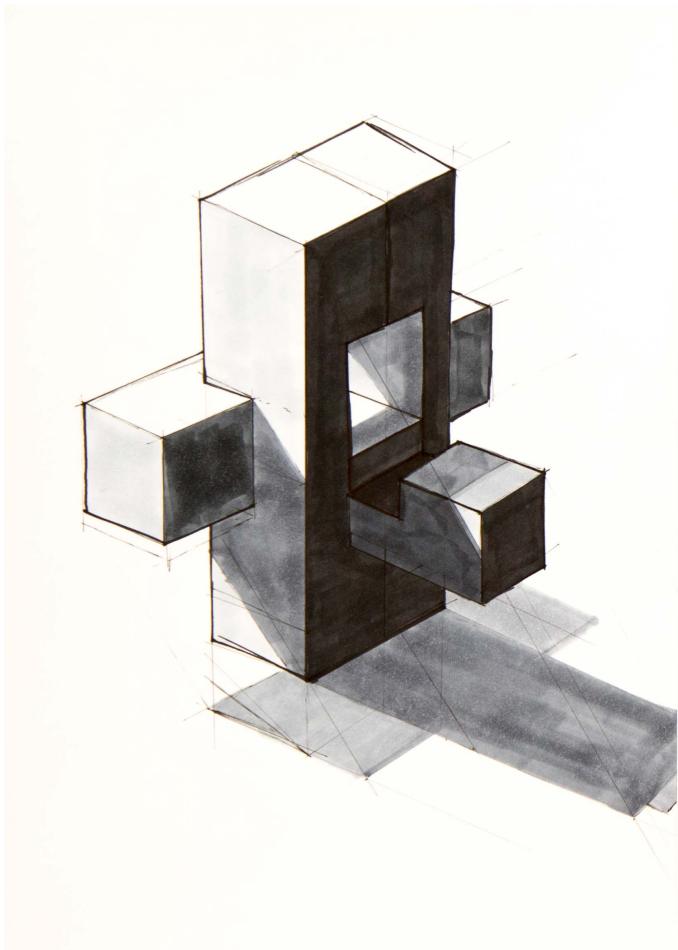

Hand-drawing—Still life

Study of light and geometry

Chinese puzzle sketch—Series showing stages of completion

Copic markers & Fine Line pigment ink

H 30cm x W 65cm



3D Product & Photography

Handcrafted Chinese puzzle

Waters and Acland furniture making school, Lake District

English walnut

H 80mm x W 80mm x L 80mm

Project to practice precision marking-out and chiseling technique with use of complex lap joints. Attended the course this summer to develop furniture making skills.

Canon EOS 7D Mk II: 1/30 sec, f/4.0, ISO 100, 105mm

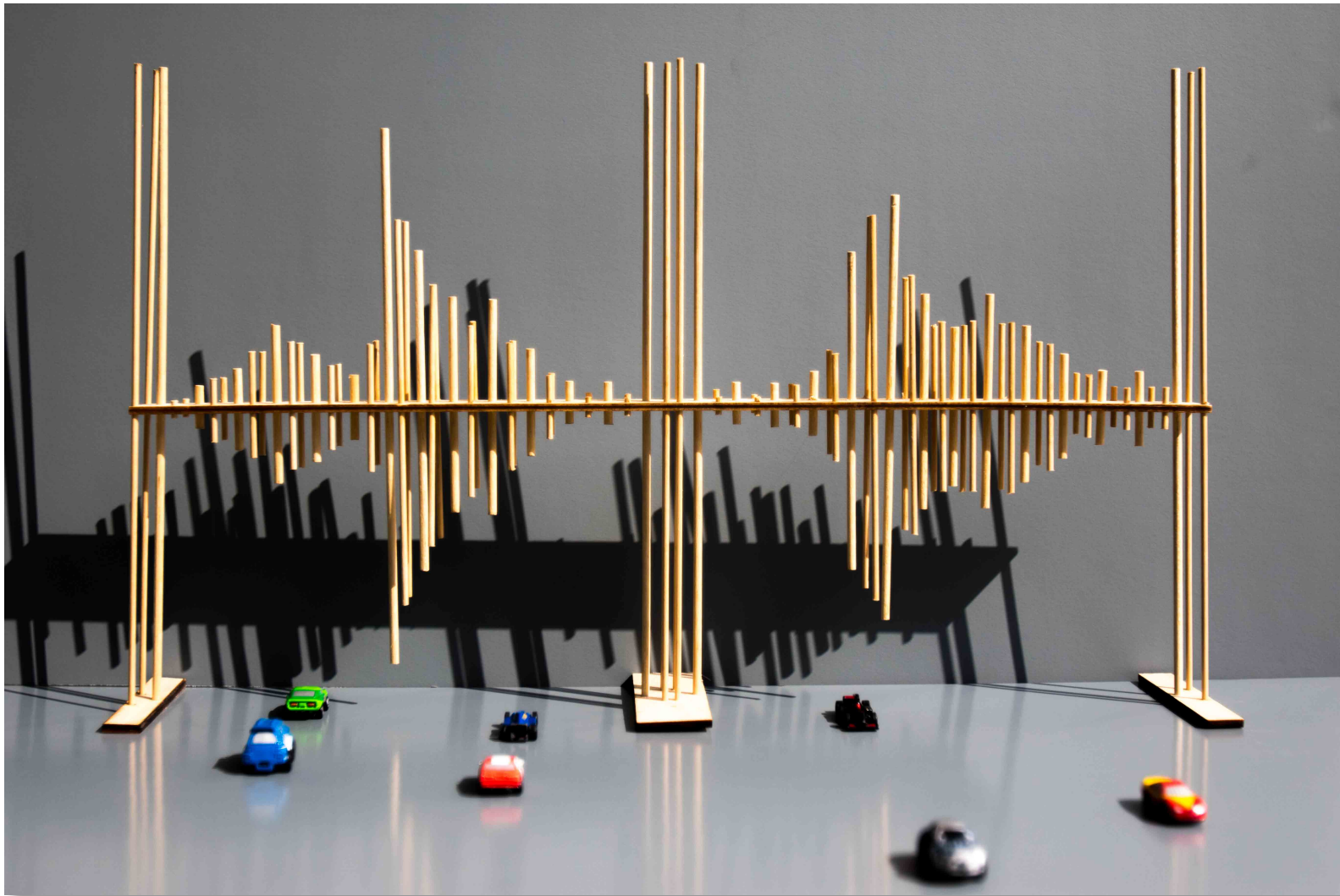

3D Product & Photography

'Sukrit Karma' pedestrian bridge

Extended Project Qualification [EPQ]—Artefact

Pine dowelling, ply

H 30cm x W 6cm x L 52cm

Modelled on the shape of the acoustic waveform of the spoken Punjabi 'Sukrit Karma', which means 'walk with God'. Connects the Sikh residents on one side of a 10-lane highway with their temple on the other.

Canon EOS 7D Mk II: 1/2500 sec, f/2.8, ISO 100, 32mm



Photography

Tunnel vision

London Underground—Tottenham Court Road

Left—Canon PowerShot G12; 1/20 sec, f/4.5, ISO 1600, 50mm

Right—Canon PowerShot G12; 1.3 sec, f/4.5, ISO 80, 35mm



To Whom it may concern,

I hereby confirm that all of the work provided within this portfolio has been completed by Jack Feather whilst studying at Jumeirah College, Dubai.

Please do not hesitate to contact me should further information be required.

Kind Regards,

Mr Graham Parkin

Head of Design and Technology

g.parkin_jcd@gemsedu.com



GEMS Education
PO Box 8607, Dubai, United Arab Emirates
T +971 (0)4 3477770 | F +971 (0)4 340 3390



[LinkedIn.com/company/gems-education](https://www.linkedin.com/company/gems-education)
[@gemseducation](https://twitter.com/gemseducation)
[gemseducation.com](https://www.gemseducation.com)

Jack David Feather

Architecture portfolio

UCAS ID 12663 80909

Thank you!